

SCOPE: Internal waterproofing of new or existing concrete block wall / brick wall and slab structures not subject to hydrostatic pressure.

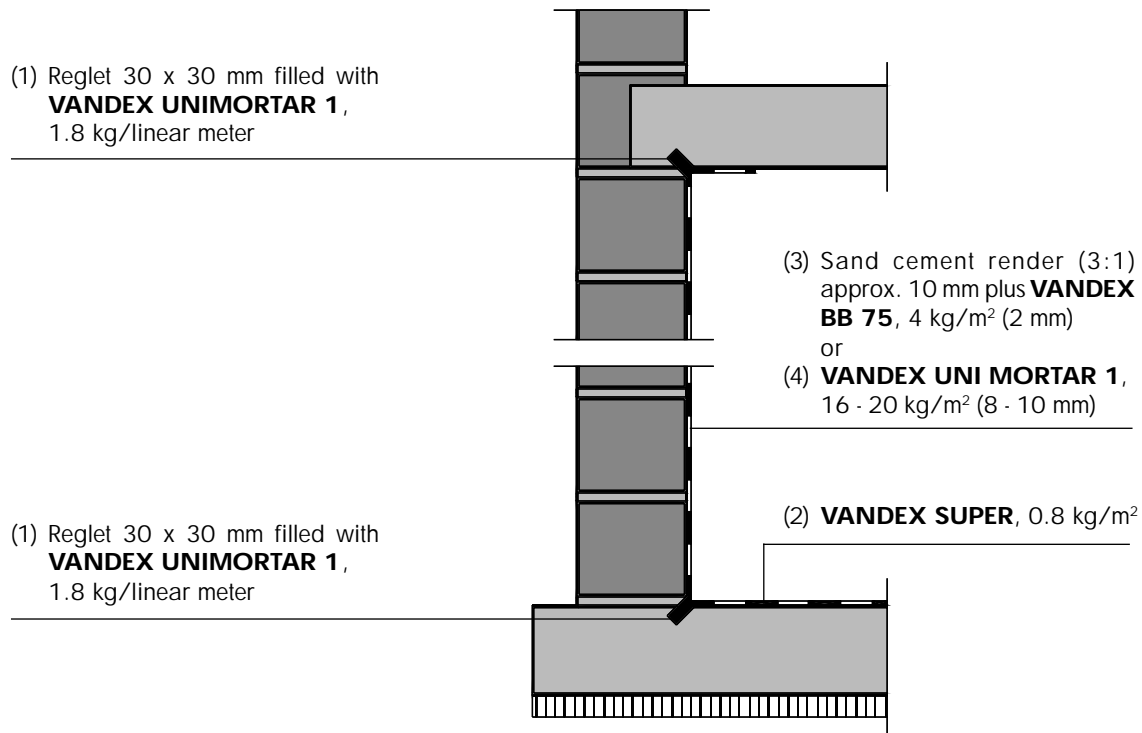

Application Instructions:

- 1.) Apply a coved fillet of VANDEX UNI MORTAR 1 at the wall / floor junction.
 - 2.) Apply one coat of VANDEX SUPER, at the rate of 0.8 kg/m² to the slab surface and footing.
 - 3.) To the vertical surface apply a sand cement render (3:1) to a thickness of approx. 10 mm. On top of the roughened surface apply one coat of VANDEX BB 75, at the rate of 4 kg/m² (2 mm).
- or
- 4.) Apply a single layer VANDEX UNI MORTAR 1, at the rate of 16 - 20 kg/m² (8 - 10 mm)

The information contained herein is based on our longterm experience and the best of our knowledge. We can, however, make no guarantee since for a successful outcome, all circumstances in an individual case must be taken into consideration. Indications of quantities required are only averages which in certain cases might be greater.